

# westin nova scotian

## property floorplans

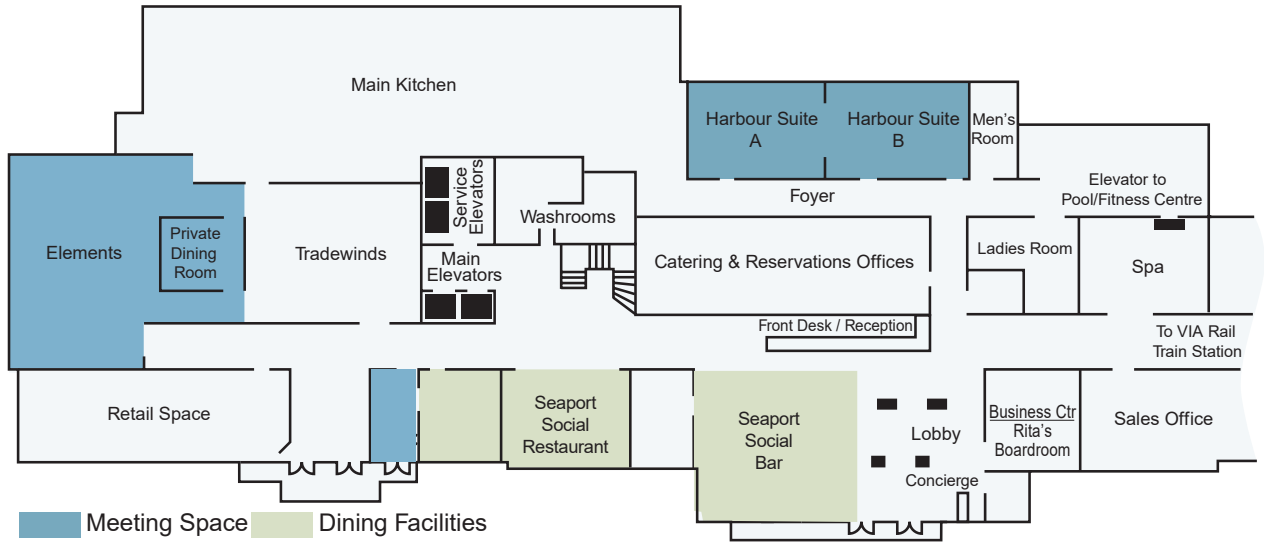

lobby level  
ground floor



conference level  
first floor

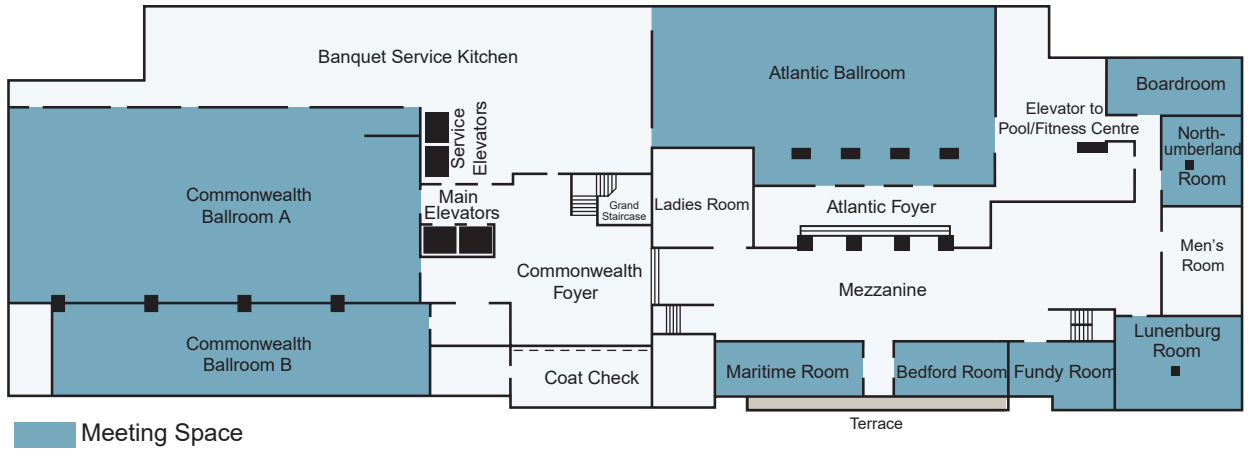

# westin nova scotian

## meeting room capacities



Meeting Room	Dimensions				Capacity									
	Room Dimensions	Square Footage	Ceiling Height	Door Height	Banquet Rounds 8/table	Banquet Rounds 10/table	"U" Shape	Classroom	Hollow Square	Theatre	Boardroom	Reception	Dinner/Dance Rounds 8/table	Dinner/Dance Rounds 10/table
Atlantic Ballroom	91 x 36	3276	15'	15'	224	240	60	180	80	315		370	176	180
Bedford	28 x 13	364	11'	11'	24	30		12		30	18	30		
Boardroom	37 x 11	407	10'6"	10'6"							20			
Commonwealth A	109 x 47	5123	14'6"	14'6"	320	350	85	250	100	600		580	248	260
Commonwealth B	96 x 20	1920	10'6"	10'6"	128	160		100	42	200		210		
Commonwealth A&B	112 x 75	8400			416	520		350		850		790	344	430
Fundy	26 x 14	364	9'6"	9'6"	16	20		16		20	16	30		
Harbour Suite A	38 x 26	988	10'6"	10'6"	48	60	30	40	34	60	30	60		
Harbour Suite B	38 x 26	988	10'6"	10'6"	48	60	30	40	34	60	30	60		
Harbour Suite A&B	76 x 26	1976	10'6"	10'6"	104	130	60	80	70	160	70	120	80	100
Lunenburg	32 x 22	704	11'	11'	32	40	20	40	20	60	20	50		
Maritime	43 x 13	559	11'	11'	24	30		24		50	24	50		
Northumberland	25 x 21	525	11'	11'	32	30		30		30	20	40		

Elements	57 x 36	2052	9'7"		*80									
Elements PDR	20 x 11	220	9'11"								12			
Ritas		280									6			

\*Existing Tables

**THE WESTIN  
NOVA SCOTIAN**  
HALIFAX

1181 Hollis Street  
Halifax, NS B3H 2P6  
902-421-1000

[Thewestinnovascotian.com](http://Thewestinnovascotian.com)

