



JW MARRIOTT  
LAS VEGAS

INSPIRED MEETINGS.  
THOUGHTFULLY CRAFTED.

EVENTS by JW

## PALMS EXECUTIVE CONFERENCE CENTER-LOBBY LEVEL

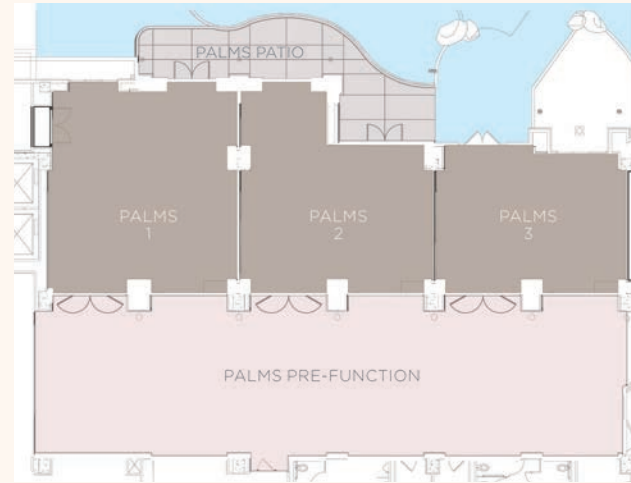
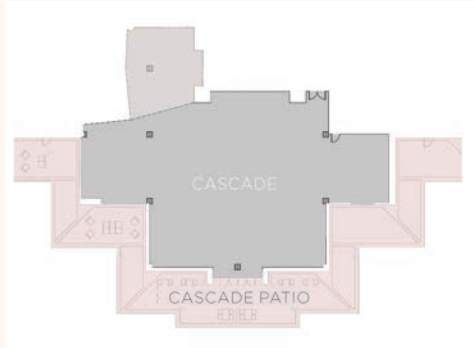

← TO PALMS TOWER LOBBY

## CULTIVATING SPACES & CONNECTIONS

When reinventing our resort and surroundings, we have ensured there are as many well-conceived spaces to inspire connection as there are quiet places to disconnect. Imagine meeting among waterfalls, streams and koi ponds, with natural lighting and outdoor patios. Our new renovations bring cutting-edge technology and audiovisual innovations to over 100,000 square feet of flexible indoor and outdoor event spaces that offer garden and mountain views and are serviced with restaurant-style culinary delights created by award-winning professionals. Whether you're booking for 50 or 500 rooms on peak nights, our relaxing resort will ensure you leave richer than when you arrived.



CASCADE

CONFERENCE CENTER-LOBBY LEVEL

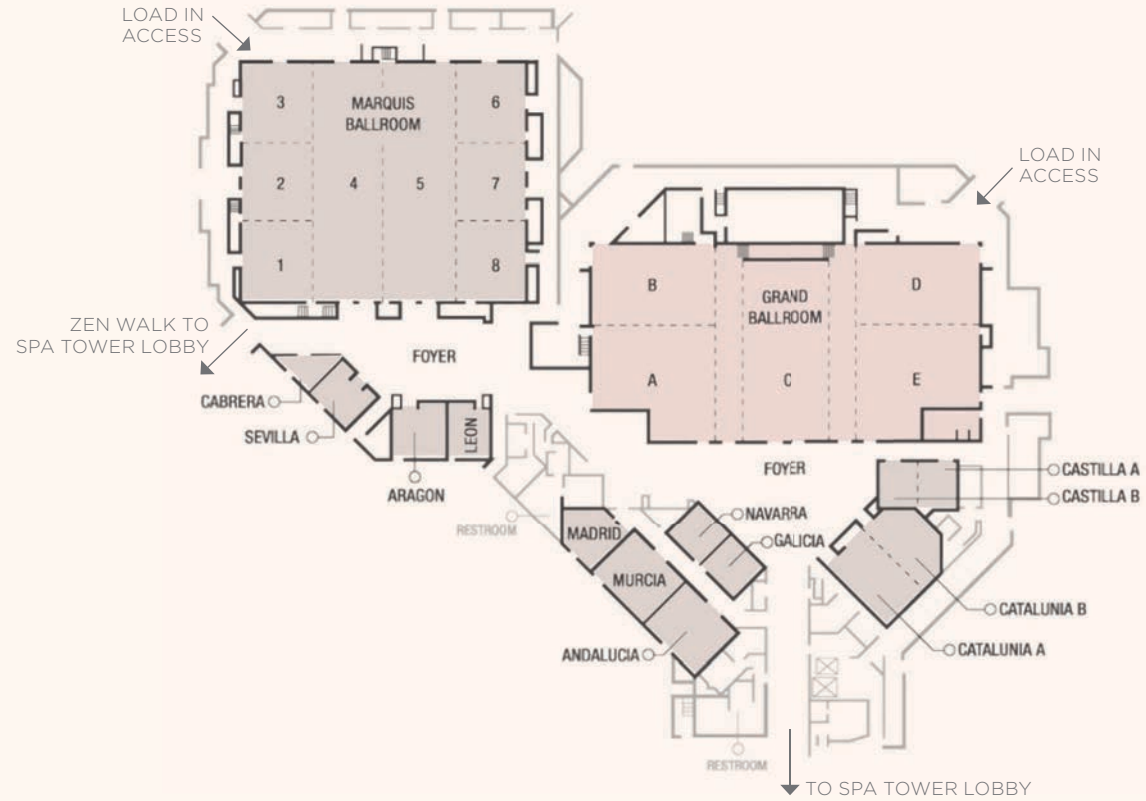
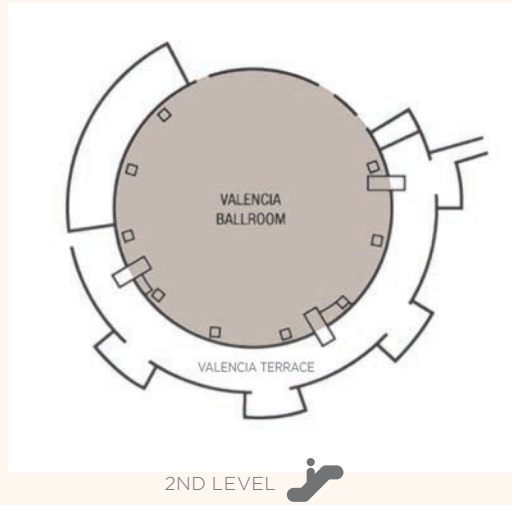

PATIO PRE-FUNCTION SPACE

INSPIRED MEETINGS  
IN INSPIRED SETTINGS

At JW Marriott, we believe that a resort is more than a place to lay your head – it is a crafted, immersive experience created by staff who love what they do. That’s why the JW Marriott Las Vegas Resort & Spa brings a new level of luxury and amenities to its guest rooms and event spaces.

Situated just 16 miles from Harry Reid International Airport and minutes from the Strip in the heart of Summerlin, our lush 54-acre resort provides a peaceful environment for a focused and productive retreat, while still close enough to the excitement of one of the world’s most famed entertainment precincts and the region’s top attractions like the Hoover Dam and Grand Canyon.

PALMS EXECUTIVE CONFERENCE CENTER-LOBBY LEVEL

	DIMENSIONS		CAPACITY							
	WxLxH	SQ. FT.	THEATRE	CLASSROOM 2/6	CLASSROOM 3/6	CONFERENCE	U-SHAPE	H SQ.	RECEPTION	BANQUET
Palms Pre-Function	96'x30'8'5"	2,680	-	-	-	-	-	-	150	-
Palms 1	32'x36'x19'3"	1,095	100	30	45	28	30	36	60	60
Palms 2	32'9"x36'x19'3"	936	68	24	36	20	30	36	70	50
Palms 3	32'6"x25'x19'3"	768	60	20	30	24	24	28	45	40
PECC	-	4,286	-	-	-	-	-	-	-	-
Parian Pre-Function	-	1,685	-	-	-	-	-	-	-	-
Parian A	51'x23'9"x12'8"	1,228	98	36	54	24	24	28	100	60
Parian B	51'x23'9"x12'8"	1,387	120	54	80	30	28	34	120	80
Parian C	31'x24'6"x8'8"	768	40	16	24	16	21	24	40	40
Parian D	19'x24'6"x12'8"	446	24	12	18	12	14	18	20	30
Parian E	26'6"x18'x9'8"	457	24	12	18	16	12	12	18	20
Parian AB	51'x51'3"x12'8"	2,615	215	94	142	26	28	20	140	140
Parian CD	50'x24'6"x8'8"	1,214	90	32	48	24	24	18	55	60
Parian Parlor	19'x44'6"x10'9"	857	60	22	33	30	-	-	70	40
Parian Patio	-	3,653	-	-	-	-	-	-	200	100
Suite 3100 or 3200	30'x30'x12'	900	80	30	45	24	25	40	80	50
Suite 6100	30'x30'x12'	480	-	-	-	15	-	-	-	-
Suite 6200	30'x54'6"x9'5"	2,888	85	45	56	22	25	40	150	60
Cascade	20.8' H high 15.4' H low	5,600	400	160	240	-	-	-	350	300
Cascade Patio	-	2,000	-	-	-	-	-	-	200	120
Lodge Inside	20'x25'x22'	500	33	16	24	26	-	-	60	40
Lodge at the Lawn	-	5,700	-	-	-	-	-	-	500	400
Lodge Patio	-	930	-	-	-	-	-	-	150	50
Pool Lawn	-	6,625	-	-	-	-	-	-	1,000	500

CONFERENCE CENTER-LOBBY LEVEL

	DIMENSIONS			CAPACITY						
	WxLxH	SQ. FT.	THEATRE	CLASSROOM 2/6	CLASSROOM 3/6	CONFERENCE	U-SHAPE	H SQ.	RECEPTION	BANQUET
Valencia Ballroom	111'x111'x14'-38'	12,320	-	-	-	-	-	-	1,000	570
Upper Level	95'x95'x38'	8,954	750	340	500	-	-	-	935	450
Lower Level	16'x210'x14'	3,366	-	-	-	-	-	-	165	120
Terrace	55'x270'x-	18,000	-	-	-	-	-	-	1,500	500
Marquis Ballroom	132'x111'x24'	14,626	F-1,280 R-1,000	F-512 R-420	F-970 R-850	-	-	-	1,200	980
Marquis 1, 3, 6 or 8	33'x37'x24'	1,235	112	36	50	28	35	46	100	60
Marquis 2 or 7	33'x36'24'	1,188	112	36	50	28	35	46	100	60
Marquis 4 or 5	33'x111'x24'	3,655	F-360 R-336	F-128 R-112	F-192 R-168	-	-	-	300	180
Marquis 4 & 5	66'x111'x24'	7,313	F-600 R-500	F-272 R-208	F-410 R-315	-	-	-	600	450
Marquis 1-4 or 5-8	66'x111'x24'	7,313	F-600 R-500	F-256 R-208	F-410 R-315	-	-	-	600	450
Marquis 1-2, 2-3, 6-7 or 7-8	33'x73'x24'	2,423	F-200 R-140	F-80 R-40	F-120 R-80	40	48	53	150	120
Marquis 1-3 or 6-8	33'x110'x24'	3,658	F-360 R-336	F-128 R-112	F-192 R-168	-	-	-	300	180
Grand Ballroom	87'3"x176'2"x19'-23'	14,409	1,250	600	800	-	-	-	1,000	-
Recessed Stage	34'x30'x34'3" above floor	864	-	-	-	-	-	-	-	-
Grand A or E	55'11"x38'11"x19'-23'	2,716	260	68	102	44	56	68	200	120
Grand B or D	55'11"x38'11"x19'-23'	1,989	200	68	102	44	56	68	200	120
Grand C	38'8"x80'7"x19'-23'	3,116	325	104	186	64	76	86	250	200
Grand C & Corridors	68'1"x86'2"x19'-23'	4,998	400	192	260	-	-	-	350	300
Grand AB or DE	55'11"x86'2"x19'-23'	4,705	F-400 R-300	F-160 R-140	F-220 R-160	-	-	-	300	240
AB or DE & Corridor	67'6"x86'2"x16'-23'	5,646	F-500 R-380	F-210 R-180	F-312 R-240	-	-	-	350	300
Grand ABC or CDE	67'6"x86'2"x19'-23'	8,762	F-725 R-600	F-300 R-240	F-450 R-380	-	-	-	600	550
Corridor	12'5"x86'2"x19'	941	-	-	-	-	-	-	-	-
Cabrera	-x-x12'	200	-	-	-	10	-	-	-	10
Sevilla	23'x21'x12'	438	24	12	18	15	16	20	40	30
Aragon	23'5"x26'x17'	611	42	16	24	18	20	28	60	40
Leon	23'5"x26'x17'	611	45	16	24	18	20	28	60	40
Madrid	15'9"x26'x12'	570	45	22	33	18	20	22	60	40
Murcia	33'5"x29'x12'	932	72	28	42	20	32	40	70	50
Andalucia	33'2"x29'x12'	925	72	28	42	20	32	40	70	50
Navarra	21'1"x20'7"x12'	425	25	10	16	16	16	20	40	20
Galicia	20'11"x20'7"x12'25"	426	12	18	16	16	20	40	20	-
Cataluna	38'x10"x46'4"x12'	1,732	198	64	96	40	48	60	150	90
Cataluna A	23'9"x39'10"x12'	943	80	32	50	28	34	40	90	40
Cataluna B	23'9"x39'10"x12'	789	50	26	42	28	32	36	80	40
Castilla	21'11"x35'3"x12'	772	60	20	30	28	30	36	60	40
Castilla A or B	17'6"x21'11"x12'	384	27	12	18	12	16	20	25	20



JW MARRIOTT

 JW MARRIOTT LAS VEGAS  
RESORT · SPA & GOLF

## CONNECT FREELY, REST EASY

Unwind in our spacious, smoke-free, luxury guest rooms and suites offering balconies, plush bedding, mini-refrigerators and large marble bathrooms with whirlpool tubs.

Guest services include 24-hour valet parking, full-service business center and executive boardroom, Hertz Car Rental service and in-room dining.

- 548 expansive, remodeled guest rooms and 79 luxury suites
- Marble bathrooms with whirlpool tubs and separate showers with raindrop showerheads
- Safe, mini-refrigerator, coffee and tea maker, iron and ironing board
- Walk-in closets with plush bathrobes
- High-speed internet, personalized voicemail, email and guest services via the HD television

## MENUS & FLAVORS TO SAVOR

Discover epicurean delights by the forkful in any of our seven restaurants or cafés. From authentic Japanese dishes like sushi and teppanyaki to smoky American steaks to traditional Italian fare, there's a world of tastes to enjoy.

### Hawthorn Grill

Savory American classics and mouthwatering steakhouse fare with waterfall views, a bar & lounge, and private dining.

### Jade Asian Kitchen

A flavorful journey through Chinese and Japanese fare. Offering Teppanyaki, Sushi and private dining.

### Spiedini Fiamma Italian Bistro

Enjoy fresh pastas, wood-fired pizzas, wine & cocktail bar, patio dining and more. Located in the Promenade.

### Earl Grey Café

Open 24/7 and located just off the casino floor, our café serves breakfast, late-night favorites and a signature three-course menu.

### Market Place Buffet

All-you-can-eat buffet featuring five action stations, plus patio dining, specialty nights and more.

### Waterside Café at the Pool

Casual poolside dining with salads, sandwiches, burgers and tropical drinks.

### Clubhouse Deli

Hot and cold subs, burgers, hot dogs, salads, soups and bagels.

### Starbucks®

Freshly brewed coffees, iced drinks, pastries and sandwiches with patio seating overlooking our grounds and herb garden.

## ENRICHING ACTIVITIES & ATTRACTIONS

Relax and enjoy a game at our casino, sun yourself at the outdoor Hydra Lounge, or get pampered at Spa Aquae.

Explore the region's exciting attractions, including the Las Vegas Strip or the Las Vegas Motor Speedway.

Discover world-class shopping at the Fashion Show Mall, Tivoli Shopping and Entertainment Complex, and Summerlin Retail District.

Get closer to nature at Red Rock Canyon National Preserve and Lake Mead and Hoover Dam, or inspire the kids with a visit to Springs Preserve or DISCOVERY Children's Museum.

### Casino

Over 1,400 slot machines and over 24 gaming tables.

### Spa Aquae

36 treatment rooms, full-service salon, whirlpools, steam saunas, hydrotherapy pool, bathing chambers and waterfall showers, 11,000 sq. ft. state-of-the-art fitness center, 2,000 sq. ft. Hydra Lounge for spa dining and relaxation.

### Pool

Open seasonally, our waterfall pool offers private cabanas, 24 hour Jacuzzi and Waterside Café.

### Activities

Bocce, volleyball, horseshoes, bike rentals, plus a variety of lawn games.

### Unique Outdoor Venues:

Lodge at the Lawn, Pool Lawn, Gazebo, Hawthorn Patio, Valencia Terrace, Cascade Terrace, Palms Terrace, Parian Terrace and Hydra Lounge.



JW MARRIOTT®  
LAS VEGAS RESORT & SPA

221 North Rampart Boulevard  
Las Vegas, NV 89145

Tel 702.869.7777  
Toll-free 877.869.8777

[jwlasvegasresort.com](http://jwlasvegasresort.com)